

KWT[®]

Keep Working Technology

Roll-Fed Labeling Machine

KWT-725 OPP



www.kwt.com.tw

Roll-Fed Labeling

■ How does KWT-725 Roll-Fed Labeler perform ?

LABEL

- Ⓐ Labels are fed to the labeling station from a label roll disk.
- Ⓑ Labels are cut , glued and applied to bottles by a vacuum drum.
- Ⓒ Labels are coated a strip of hotmelt at the beginning and a strip of hotmelt at the end by glue wheel.

CONTAINER

- ④ Bottles (containers) enter this machine at infeed conveyor and separated by separating screw.
- ⑤ Bottles (containers) are delivered to vacuum drum by front star-wheel, carry the glued labels then wrap-around labels are seated exactly and perfectly by turning disk.



- ⑤ After finishing the process of labeling, bottles are exited by outlet conveyor.

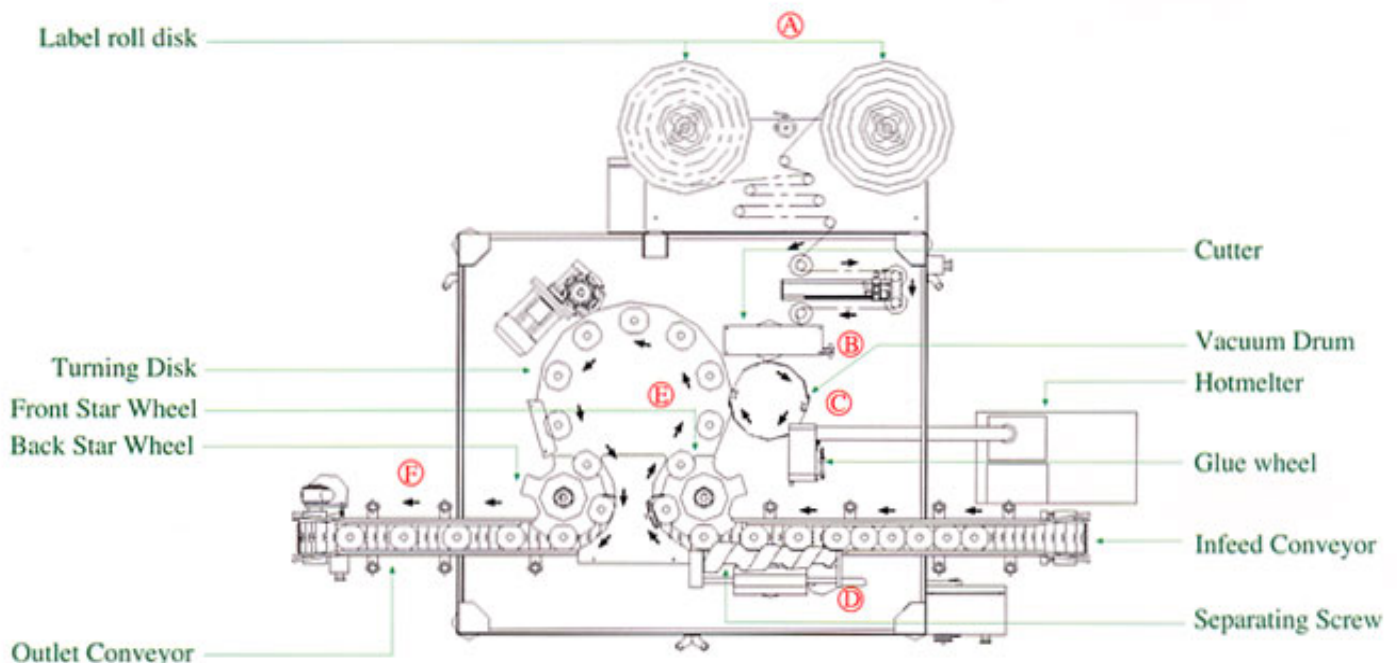

Machine



Minimize consumption

LEBAL coated only the leading and trailing edges of the label.

The first impression should remain the best when consumers stand face to face with your bottles on the shelf.

Prerequisite is quality labeling and flawless implementation of your marketing concept.

KWT-725 is predestine above for PET bottles. Modern technology and not a fad applying roll-fed wrap-around labels to bottle. Today, not only paper labels but also attractive plastic film labels.

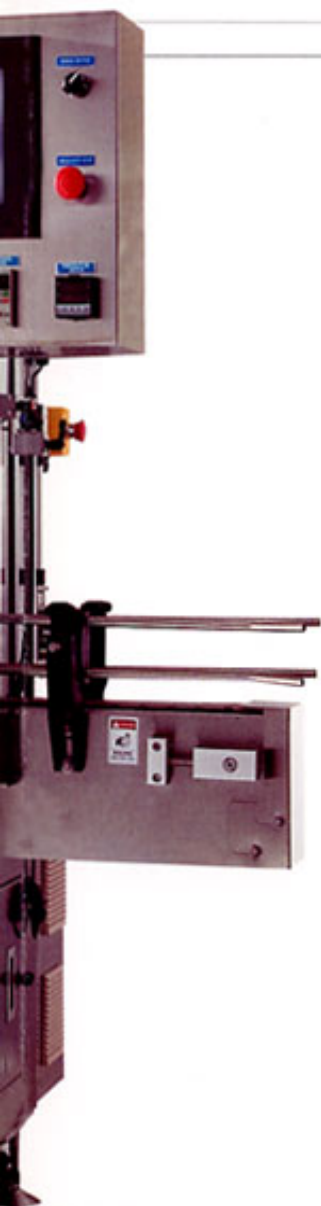

■ Color touch screen



■ Double reel holder

APPLICATION :

Suitable for mineral water, milk, soymilk, yogurt's PET, PVC, PE bottle wrap-around labeling with OPP web.

FEATURES :

1. Machine meets CE standards.
2. Machine meets GMP standards.
3. Modular design , replace changing parts easily and swiftly.
4. Mitsubishi PLC combined with 10" color monitor human / machine interface LCD touch screen controller.
5. Machine can apply for handling round / square / hexagon containers.
6. Main construction frame made by iron inside and stainless steel outside, including water-proof protection.
7. Labeling head is driven by YASKAWA servo motor and driver (Japan made).
8. Nordson brand hotmelter (USA made).
9. Single straight conveyor design – saving cost and saving space.
10. Double reel holder – high performance based on virtually continuous operation.
11. Control cabinet integrated in the machine housing – Space saving design.



■ Hotmelter



■ Separating screw & star wheel guide



■ Vacuum drum & glue wheel

■ Dimension & Specification

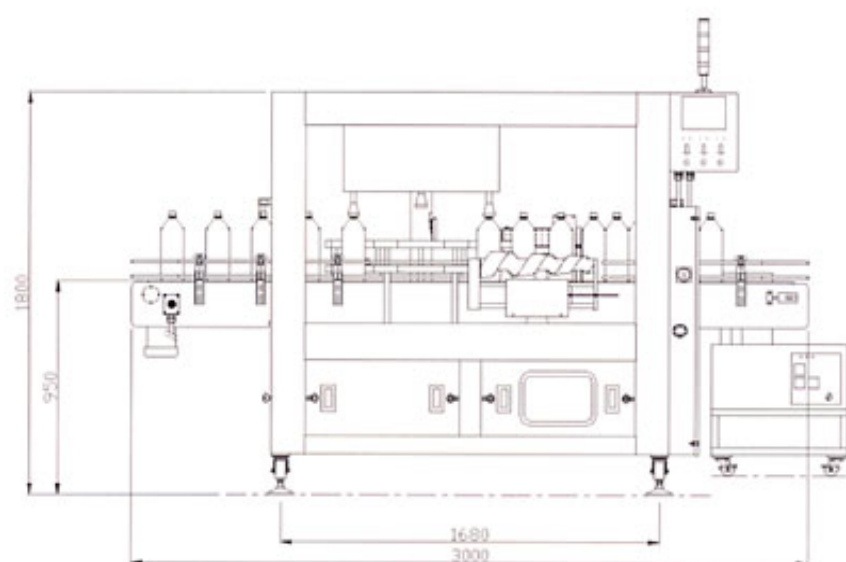

FRONT VIEW

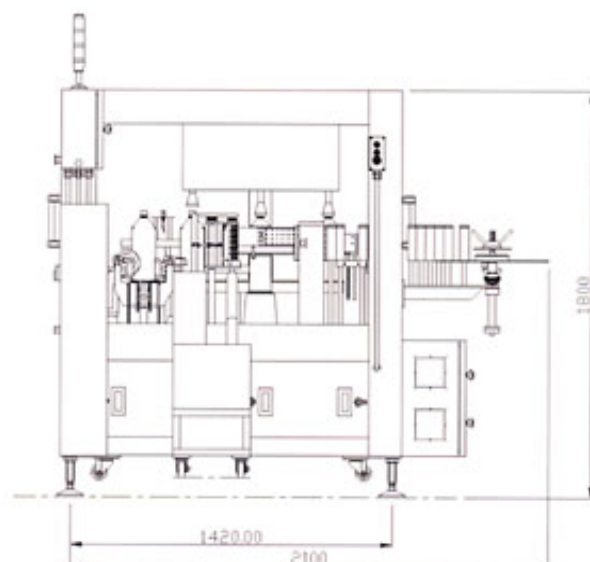

SIDE VIEW

Output Speed	150 ~ 300 BPM (Bottle Per Minute)
Size of Bottle (mm)	H : 150 ~ 350 mm , ID : 50 ~ 150 mm.
Size of Label (mm)	H : 30 ~ 150 mm , L : 30 ~ 350 mm.
Diameter of Label Roll (mm)	150 ~ 500 mm
Accuracy (mm)	± 2 mm (Depends on bottle shape)
Power Supply	220V , 50/60 Hz , 3 Phase.
Air Consumption	0.4L / Min.
Power Consumption	3.8Kw
Hotmelter & Hose	5.4Kw
Ring Blower	50/60Hz 1.5kw
Material of Label	OPP / Paper / Pearl Paper
Material of Bottle (container)	PE / PET / PVC
Control System	PLC combined with LCD Touch screen.
Machine Dimension (mm)	3000 (L) x 2100 (W) x 1800 (H) mm.
Machine Weight (kg)	2000kg
Change Parts	Product Separating Screw, Star-Wheel (Front and Back) , Star-Wheel Guide, Vacuum Drum.



Keep Working Technology

KWT Machine Systems Co., Ltd.

No. 21, Taiping 21 Street, Taiping City, Taichung Hsien 41199, Taiwan

Tel: 886-4-2277 3390

Fax: 886-4-2277 3412

E-mail: sales@kwt.com.tw

[http:// www.kwt.com.tw](http://www.kwt.com.tw)