



SINCE 1979

# HEMINGSTONE

THE FIRST CHOICE

**HM-800W**

**HM-800W+CK**

**HM-1000W**

High Speed Automatic Wicketer  
with Servo Motor Drive System

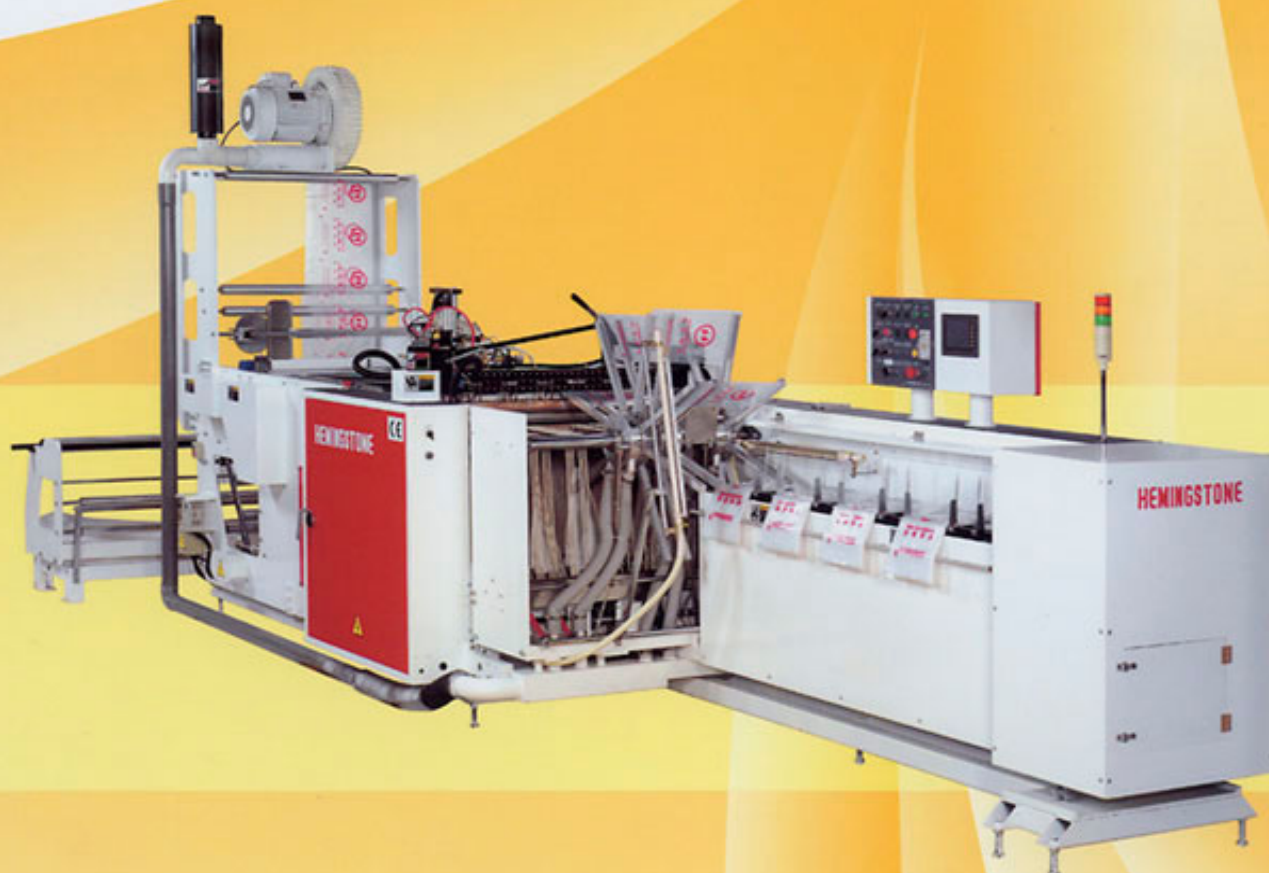

# Bag Making Machine

**HM-800W**

**HM-800W+CK**

**HM-1000W**

High Speed Automatic Wicketer  
with Servo Motor Drive System

( CK : for Chicken Bag )

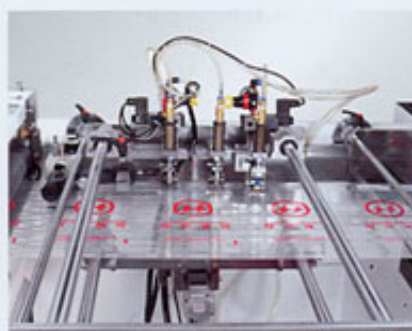

## ROUND PUNCHING UNIT :

The Round Punching Knife is changeable. This unit is well designed for easy replacing and low maintenance. Meanwhile, the machine is able to run at high speed.



## 8-ROTARY-ARMS UNIT :

The collection of bags is by 8 Rotary Arms designed in vacuum type to take the bags easily. Even the machine operates in high speed, the speed of the arms is slow. It could decrease the coefficient of wind resistance, and take the bags precisely.

## SPECIFICATIONS :

MODEL	BAG SIZE		PRODUCTION SPEED (CYCLES/MIN.)	THICKNESS OF FILM (MM)	HEATERS	POWER REQUIRE
	WIDTH	LENGTH				
HM-800W	90-330mm	300-700mm	Bakery PE: 300 / Max. PP: 200 / Max.	0.015~0.07	2.1 kw	7 kw
HM-800W+CK			Bakery PE: 300 / Max. PP: 200 / Max. Chicken Bag: 200 Max.		2.1 kw x 1 0.3 kw x 2	7.6 kw
HM-1000W	90-330mm	300-900mm	Bakery PE: 300 / Max. PP: 200 / Max.	0.015~0.07	2.8 kw	8 kw

\* Maximum operating speed depends on bag size, material and operating conditions. Specification is subject to change without notice.



Please visit the website [www.machinesources.com](http://www.machinesources.com) and key in the Video Serial Number **EB61607** to watch the product running in actual production environment.

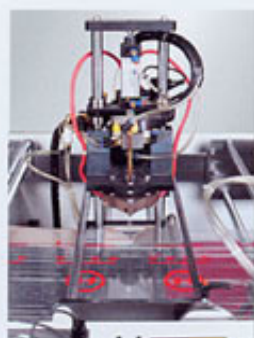

#### ROUND BOTTOM SEALING FOR CHICKEN BAG : (Optional accessory)

**\* For model HM-800W+CK**

Special design round bottom sealing unit (double arcs type) for chicken bags. Both sides can be heated independently, so the sealing is strong. The speed is 170 pcs/per min.

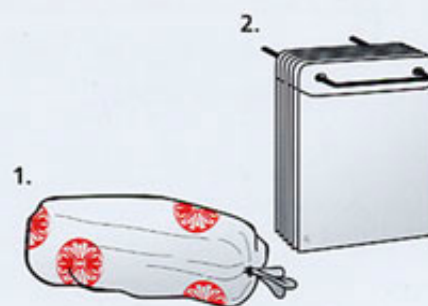

#### DIAGRAMS OF BAGS ABOVE

1. Bottom Gusseted Bakery Bag.
2. Wicketed Bag Stack.

Converters producing bags for bakery items, ice, fruit, general products or clothing products will benefit from innovations which exceed today's standards for high speed continuous operation.

#### EFFICIENT OPERATION

1. Servo controlled sealing mechanism allows variable & precise control while the machine is running.
2. Automatic print registration correction is accomplished with a photo-electric print sensor.
3. The wicketing conveyor ensures improved hole alignment and stacking on the pins.
4. Micrometer calibrated seal bar adjustments control seal bar penetration, ensuring uniform bag seals.

#### REDUCED MAINTENANCE

1. The built in diagnostic system reduces down time.
2. The seal head assembly pivots 90° from the operating position for easy maintenance.
3. Upper and lower draw roll assemblies are easily removed for maintenance. The design ensures accurate re-assembly.
4. The linear potentiometer controlling the web drive is easy adjusted and serviced.

#### INCREASED PRODUCTION

1. Each indexing station is equipped with stacking pins that can be adjusted to accommodate various wicketed sizes.
2. Low inertia idler rollers and pivoting dancer arm minimize web bounce and maintain precise web tension.
3. Easy set up of machine functions reduces set up time.
4. The High Speed Hemingstone HM-800W and HM-1000W Wicketing Machines offer a number of features which perform well as competitive machines.
5. The 355mm(14") arm can run up to 300 cycles/min.
6. The servo controlled main drive provides uniform cut off, reliable service and minimum maintenance.

D	MACHINE DIMENSIONS			GROSS WEIGHT (KG)	NOT INCLUDED	
	L (m)	W (m)	H (m)			
	8.0	3.0	1.85	2200	Air Compressor 7.5HP	PP Sealing Knife (Optional)
	8.0	3.2	1.85	2800	Air Compressor 7.5HP	PP Sealing Knife (Optional)

Please visit the website [www.machinesources.com](http://www.machinesources.com) and key in the related Video Serial Number  **EB61601** to watch the HEMINGSTONE company profile.



SINCE 1979

# HEMINGSTONE

THE FIRST CHOICE

峰明機械有限公司

**HEMINGSTONE MACHINERY CO., LTD.**

NO. 41, WU-KONG 5TH RD., WU-KU INDUSTRIAL PARK, WU-KU HSIANG, TAIPEI HSIEN, TAIWAN

TEL: 886-2-2299-1616, 2299-5700

FAX: 886-2-2299-2070, 2299-2080

E-mail: [hm.stone@msa.hinet.net](mailto:hm.stone@msa.hinet.net)

[hm\\_mail@hemingstone.com](mailto:hm_mail@hemingstone.com)

<http://www.hemingstone.com>